

Article number: 20056511

Description: E+G Quick-fit coupling (radial displacement)  
GN 240.1-M10-A

## Measures

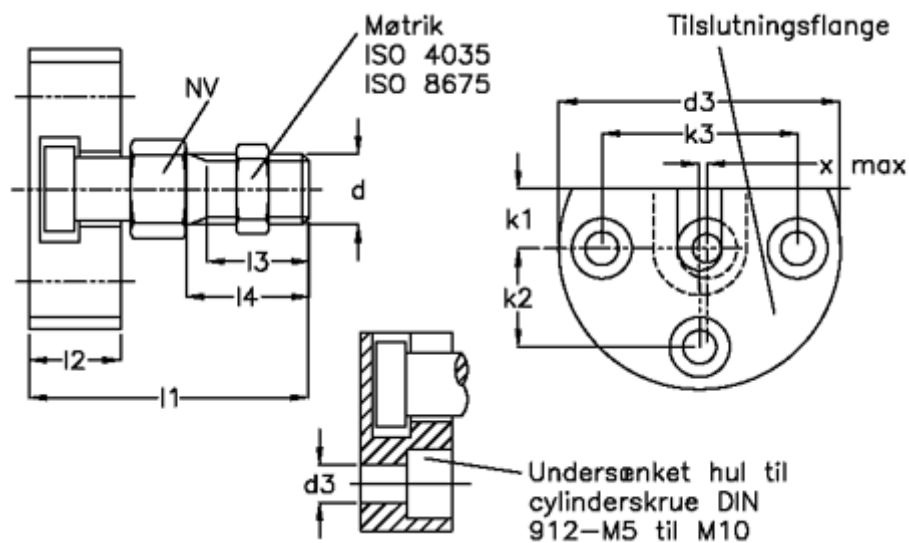

d1 = M 10x1,5	l3	= 16.0
d2 = 50	l4	= 20
d3 = 6.5	Max displacement	= 0.7
k1 = 9.0	Max push-pull strength N	= 6500
k2 = 17.0	NV	= 17
k3 = 34		
l1 = 43.0		
l2 = 16.0		